

PLAN COMPILED IN ACCORDANCE WITH REGULATION 42 OF THE MINING TITLE'S REGISTRATION ACT, (ACT 16 OF 1967).				
MINING RIGHTS AREA CO-ORDINATES:				
CO-ORDINATES: WG 25° TOPOGRAPHICAL				
MAP: 3023 DB & 3024 CA			GEOGRAPHIC CO-ORDINATES	
Y		X	LATITUDE (South)	LONGITUDE (East)
A	+97 012.52	+3 398 974.89	30°42'26.72" S	23°59'14.32" E
B	+95 583.55	+3 399 003.38	30°42'28.06" S	24°00'08.01" E
C	+95 051.19	+3 399 377.02	30°42'40.34" S	24°00'27.88" E
D	+95 077.76	+3 399 807.72	30°42'54.32" S	24°00'26.74" E
E	+97 143.92	+3 399 589.89	30°42'46.65" S	23°59'09.18" E
F	+97 118.52	+3 399 433.59	30°42'41.58" S	23°59'10.18" E
G	+97 103.42	+3 399 436.39	30°42'41.67" S	23°59'10.75" E
H	+97 087.82	+3 399 438.49	30°42'41.75" S	23°59'11.33" E

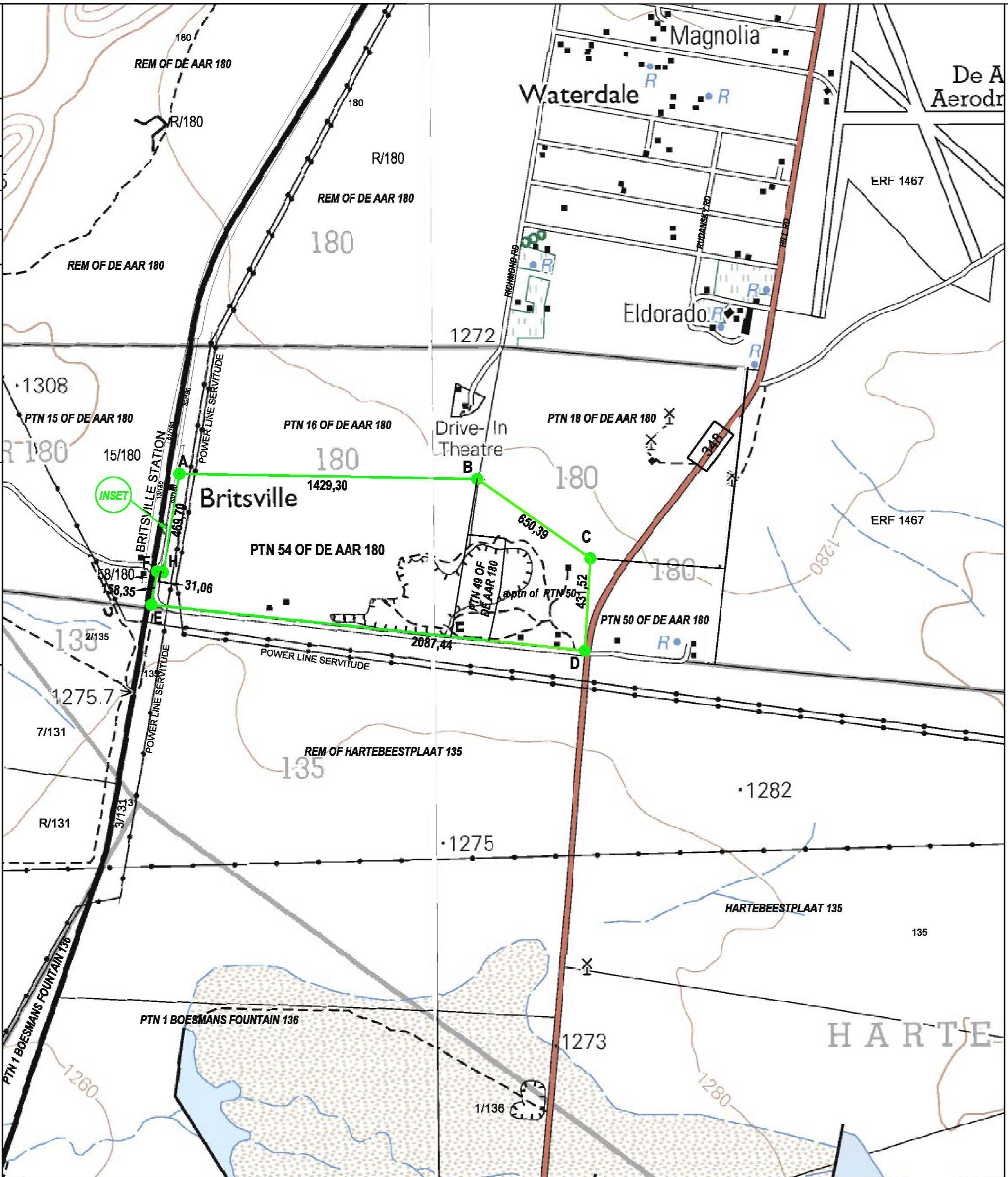
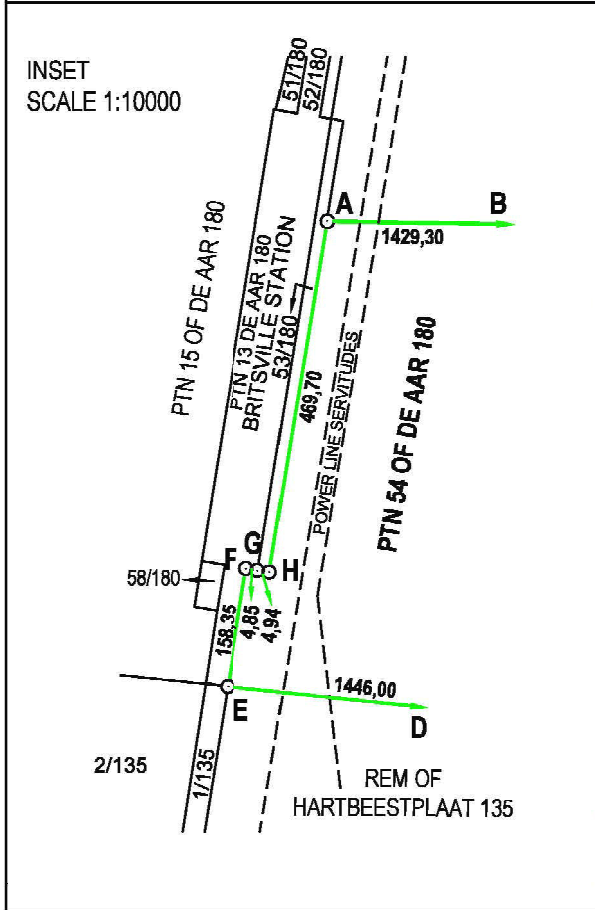
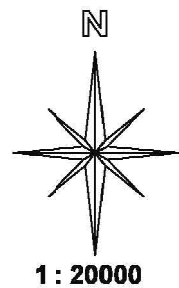

<b>APPLICANT: DE AAR STONE CRUSHERS EMPOWER (Pty) Ltd. REG No. 2013/217985/07</b>
PLAN COMPILED IN ACCORDANCE WITH REGULATION 42 OF THE MINING TITLE'S REGISTRATION ACT, (ACT 16 OF 1967)
<b>APPLICATION: SECTION 102 (MINING RIGHTS)</b>
1. The figure ABCDEFGH represents the mining right area, extent 133,1830 hectares overall, comprising of Portion 54 of the farm DE AAR 180; Portion 49 of the farm DE AAR 180 and a portion of Portion 50 of the farm DE AAR 180. Situate in the Magisterial District of HANOVER
2. Cadastral data was calculated from S.G. Diagrams No. F8840/1970; F9078/1965 and F1607/1965 and it was verified for no encroachment and information supplied by the applicant.
Compiled and certified by me in May 2025 from available Surveyor-General data and information supplied by the applicant.  <b>D.R. VAN ZYL PLS 1344</b> Professional Land Surveyor
DE AAR STONE CRUSHERS EMPOWER (Pty) Ltd Registration No. 2013/217985/07 has applied for mining rights area in terms of Section 102 of the Mineral and Petroleum Resources Development Act, (Act 28 of 2002).
APPLICANT SIGNATURE: <b>JS LAMBRECHTS</b>
DATE: ..18/..11/..2025.....
REGIONAL MANAGER: DEPT. MINERAL RESOURCES
SIGNATURE: .....
DATE: .....
DEPT. OF MINERAL AND ENEERGY
SIGNATURE: .....
DATE: .....
SUBJECT TO REGULATION 17 OF THE MINE HEALTH AND SAFETY ACT EXCLUDING ANY AREA WITHIN 100 METRES OF ANY PUBLIC ROAD, RAILWAY, RIVERS, CEMENTARY, RESIDENTIAL AREA OR PUBLIC AREA.